

## ZYYX Connect Install and Getting Started Instruction

**Parts:** The package consists of four parts (plus screws), as show right:

1. Raspberry Pi computer board (RPi)
2. RPi to ZYYX adapter cable
3. Micro-SD card with OS and ZYYX Octoprint installation
4. Four pin socket, which may be needed if you ZYYX board lacks this



**Installation:** Power down the printer and remove the power cable. Remove bottom lid by 2 screws inside printer and 2 on the bottom side. For newer ZYYX Pro it may be 4-7 screws at bottom only, if it uses the flat bottom plate.

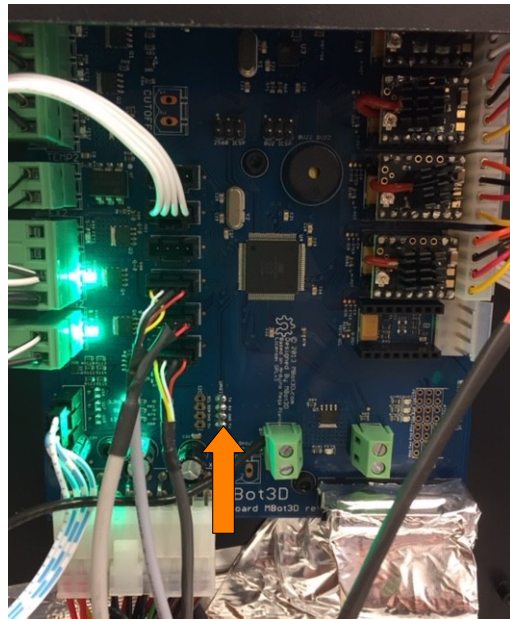

Then make sure you have prepared an ESD safe environment including suitable tools so you do not damage the electronics.

When this is done, locate the UART connector on the printer motherboard. As shown to the left. If it is missing, it will need to be soldered to the board.

Mount the ZYYX connect board in the back corner of the printer, with ports facing backwards. Use the included M3 screws for mounting the board.

Make sure the end of the rectangular connector marked with colour is towards the end of the connector on the ZYYX Connect board, as shown right.

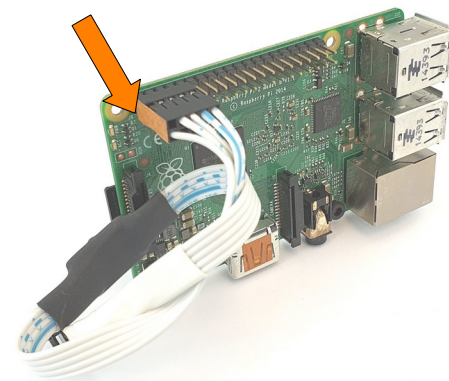

Then attach the cable to the UART port as shown in picture above. Make sure that the lock mechanism of the connector is oriented to the right.

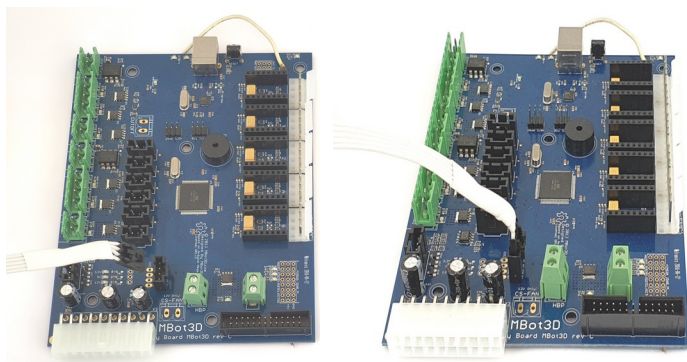

Next reassemble the printer and put back the bottom lid and reattach the screws. Then connect a network cable and power on the printer. After a few second the IP number will be shown on the printer screen.

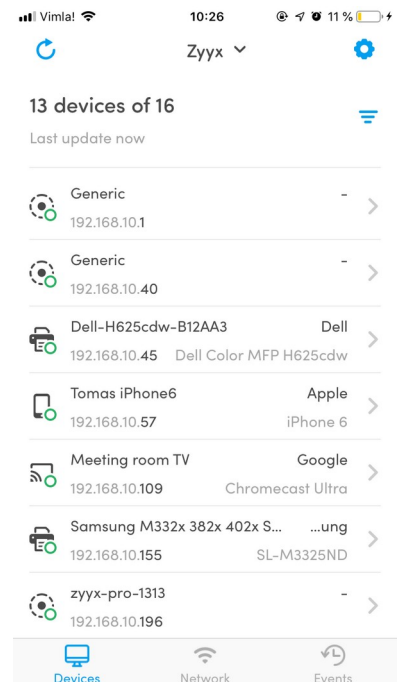

If the IP number is not being displayed, first set Serial I/O (see next page). You can alternatively use a network tool to find the IP number. Easiest is to use the freeware tool "Fing" on your phone (available for both iPhone and Android), see picture to the right. Alternatively you can use Bonjour Browser, ZeroConf, or similar software. Look for zyyx-pro-XXXX or zyyx-plus-XXXX, where XXXX is the last four or five digits of the serial number.

# Installationsanvisningar/Assembly Instruction

ZYYXs dok.kod/ZYYX's doc. code Art.version Dok.utgåva/issue – Datum/date Artikelnamn/Article name Art.kod/Art. code Godkänd/Appr.  
D2.0161 - B - 2020-03-25 ZYYX M1.0146

Finally, to allow the new board to communicate with the printer, you must also go into the printer menu and find the "Serial I/O" setting and adjust it to "UART1", as shown below.

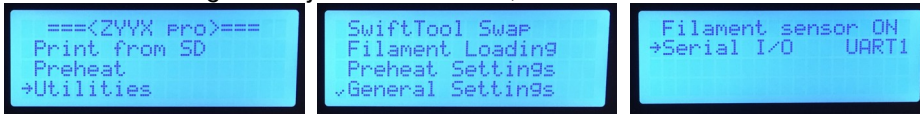

Then start a web browser and go to the ip number you found in previous step, in this case 192.168.10.188.

Login with user name "zyyx" and as password your printer's serial number. It may also be worthwhile to save the password for next time.

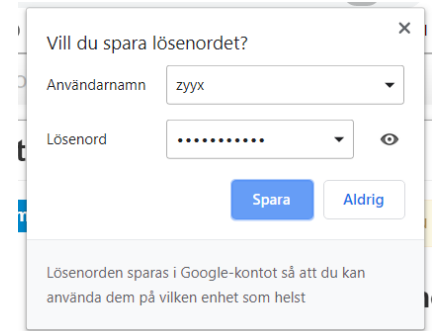
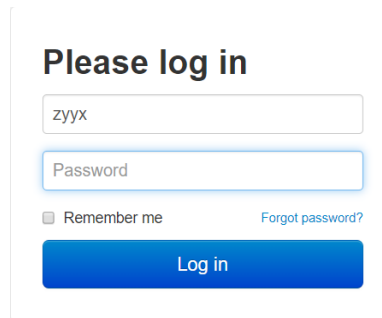

Below you can see the main Octoprint user interface.

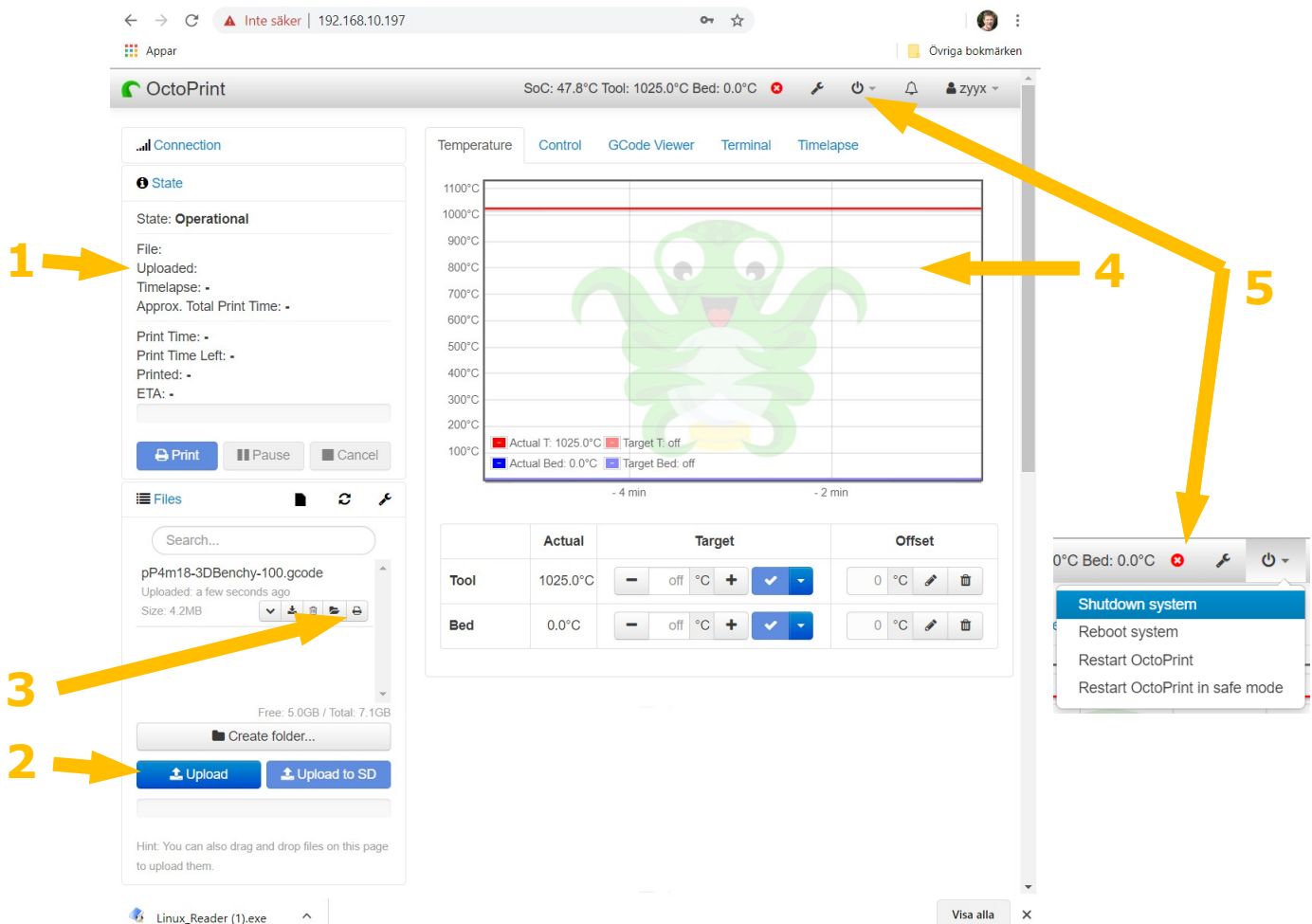

1. Status section.
2. Upload files to control board or SD card. SD support only x3g files as usual, but from the control board you must use gcode files (both are created by Simplify3D).
3. Upload files to board or SD.
4. Temperature monitor and optional web camera display.
5. Power control. It is good practice to power the system down here to avoid possible memory corruption.

# Installationsanvisningar/Assembly Instruction



ZYYXs dok.kod/ZYYX's doc. code    Art.version    Dok.utgåva/issue – Datum/date    Artikelnamn/Article name    Art.kod/Art. code    Godkänd/Appr.  
D2.0161    -    B - 2020-03-25    ZYYX    M1.0146

## Dokumenthistorik/Doc history

Utgåva Issue	Giltig från Date	Utförd av Done by	Gjord ändring Change
A	2020-01-20	TB	First issue of ZYYX Connect assembly instruction.
B	2020-03-25	TB	Added board and parts pictures.